

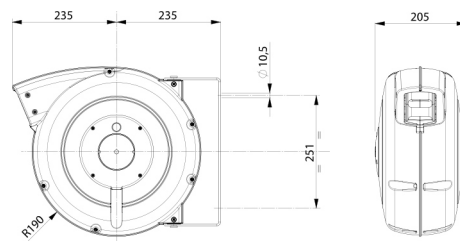

# Cable reel Magnum 7000



- Spring rewind mechanism
- Latching system
- Max. 27m cable
- Plastic casing shockproof and UV-resistant
- Swiveling mounting bracket
- Mountable in any position
- Protection type IP42

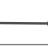

No. of conductors	Conductors section (mm <sup>2</sup> )	Cable length	Max. Watt 	Max. Watt 	V max. (test load)	Cable type	Slipping	Item-No.
1	16mm <sup>2</sup>	22m	-	-	-	H05V-F	10A	2.300.001
2	1,5mm <sup>2</sup>	27m	1100	1800	500V	H05VV-F	10A	2.300.002
3	1,5mm <sup>2</sup>	27m	1100	1800	500V	H05VV-F	10A	2.300.003
3	2,5mm <sup>2</sup>	22m	2000	3000	500V	H05VV-F	10A	2.300.004
4	1,5mm <sup>2</sup>	27m	1100	1800	500V	H05VV-F	10A	2.300.005
4	2,5mm <sup>2</sup>	20m	2000	3000	500V	H05VV-F	10A	2.300.006
5	1,5mm <sup>2</sup>	22m	1500	2200	500V	H05VV-F	10A	2.300.007
5	2,5mm <sup>2</sup>	17m	2000	3000	500V	H05VV-F	10A	2.300.008
3	1,5mm <sup>2</sup>	22m	1100	1800	750V	H07RN-F	10A	2.305.003
3	2,5mm <sup>2</sup>	19m	2000	3000	750V	H07RN-F	10A	2.305.004
4	1,5mm <sup>2</sup>	18m	1100	1800	750V	H07RN-F	10A	2.305.005
4	2,5mm <sup>2</sup>	15m	2000	3000	750V	H07RN-F	10A	2.305.006
5	1,5mm <sup>2</sup>	17m	1500	2200	750V	H07RN-F	10A	2.305.007
5	2,5mm <sup>2</sup>	12m	2000	3000	750V	H07RN-F	10A	2.305.008

Cable reel with 3x1,5mm<sup>2</sup>, 3x2,5mm<sup>2</sup> incl. Schuko plug and socket

Cable reel with 5x1,5mm<sup>2</sup> incl. CEE-connection 16A

Cable reel with 5x2,5mm<sup>2</sup> incl. CEE-connection 32A

Accessories	Item-No.
Device to fix the wall bracket	2.309.001

