

Hose reel OSM 500 Duo

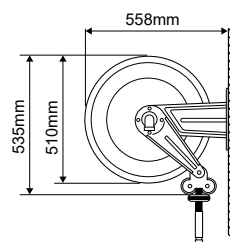

- Suitable for passing through 2 different media
- Spring rewind mechanism
- Latching system
- max. 14m hose - max. 2x15mm Ø outside
- Casing in painted steel
- Fixed mounting bracket
- Adjustable hose guide
- Mountable in any position

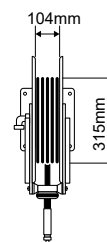
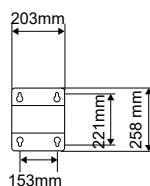
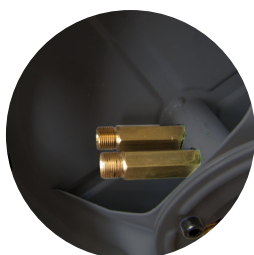

Painted Steel



Medium	Length of the hose	Inner Ø	Max. pressure	Max. temp.	Swivel	Swivel connection	Armature	Item-No.
Air / water	without hose	2x15mm	20bar	90°C	viton / brass	2x 1/2" F	-	1.500.1000
Oil / water	without hose	2x15mm	200bar	130°C	viton / stainless steel	2x 3/8" F	-	1.500.3000
Oil / paint	without hose	2x15mm	200bar	130°C	polyurethane / steel	2x 3/8" F	-	1.500.4000
Oil	without hose	2x15mm	400bar	130°C	polyurethane / steel	2x 3/8" F	-	1.500.5000
Oil / water	without hose	2x15mm	700bar	130°C	viton / PTFE	2x 3/8" F	-	1.500.6000

Optional accessories

Designation	Material	Item-No.
Extension for swiveling wall bracket 180°	stainless steel	1.514.007
Swivling wall bracket, 110°	painted steel	1.510.001
Swivling wall bracket, 110°	stainless steel	1.514.001
Hose trolley with 4 breaking solid rubber wheels with 4 breaking air wheels	steel zinced	130.001 130.002



The changeover to RAL 7016 will take place successively

