

Hose reel OSM 610 Duo

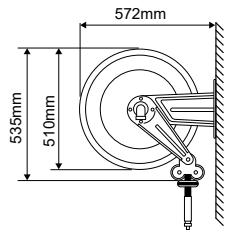

- Suitable for passing through 2 different media
- Spring rewind mechanism
- Latching system
- max. 15m hose - max. 2x15mm Ø outside
- Casing in painted steel
- Fixed mounting bracket
- Adjustable hose guide
- Mountable in any position

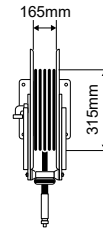
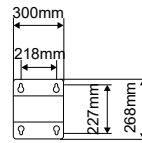
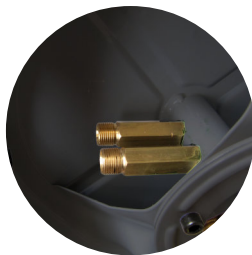

Painted steel



Medium	Length of the hose	Inner Ø	Max. pressure	Max. temp.	Swivel	Swivel connection	Armature	Item-No.
Air / Water	without hose	2x15mm	20bar	90°C	viton / brass	2x 1/2" F	-	1.600.1000
Oil	without hose	2x15mm	400bar	130°C	Polyurethane / steel	2x 3/8" F	-	1.600.5000
Oil / Water	without hose	2x15mm	700bar	130°C	viton / PTFE	2x 3/8" F	-	1.600.6000

Optional accessories

Designation	Material	Item-No.
Swivling wall bracket, 110°	painted steel	1.610.007
Swivling wall bracket, 110°	stainless steel	1.614.007
Hose trolley with 4 breaking solid rubber wheels with 4 breaking air wheels	steel zinced	130.001 130.002

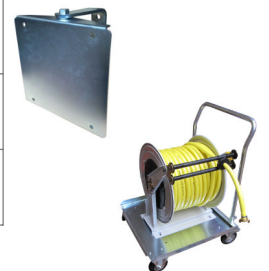

The changeover to RAL 7016 will take place successively

